

AC

COURTESY OF  
**MASCOTT EQUIPMENT COMPANY**  
Portland Seattle Tri-Cities  
[www.mascottec.com](http://www.mascottec.com)

**03A20-B**

S/N 751140 UP

PUMP ISSUE 2

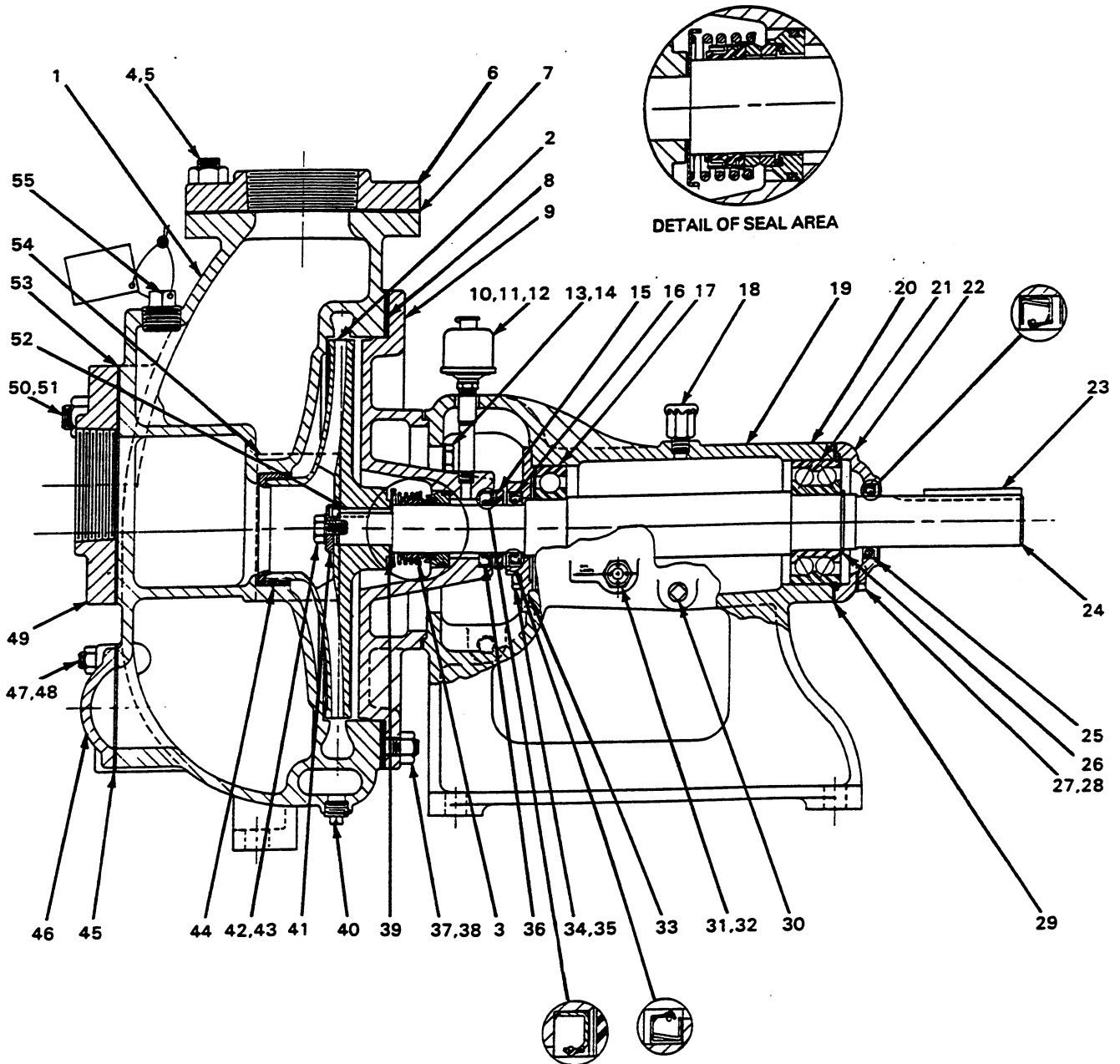

**THE GORMAN-RUPP COMPANY • MANSFIELD, OHIO**

OCTOBER 20, 1982

1 of 2  
page 110.3 A7

# 03A20-B

S/N 751140 UP

PUMP ISSUE 2

| ITEM NO. | PART NAME            | PART NUMBER | MAT'L CODE | QTY | ITEM NO.   | PART NAME          | PART NUMBER | MAT'L CODE | QTY |
|----------|----------------------|-------------|------------|-----|------------|--------------------|-------------|------------|-----|
| 1        | VOLUTE HOUSING       | 4156A       | 10010      | 1   | 32         | PIPE PLUG          | P06         | 15079      | 1   |
| 2 *      | IMPELLER             | 4170B       | 10010      | 1   | 33         | BEARING CAP        | 7622        | 10010      | 1   |
| 3 *      | SEAL ASSY            | 12451A      | ---        | 1   | 34         | HEX HD CAPSCREW    | B0403       | 15991      | 4   |
| 4        | STUD                 | C1009       | 15991      | 4   | 35         | LOCKWASHER         | J-04        | 15991      | 4   |
| 5        | HEX NUT              | D10         | 15991      | 4   | 36         | OIL SEAL           | S506        | ---        | 1   |
| 6        | DISCH FLANGE         | 1753A       | 10010      | 1   | 37         | STUD               | C0807       | 15991      | 12  |
| 7 *      | DISCH FLNG GSKT      | 1674GB      | 20000      | 1   | 38         | HEX NUT            | D08         | 15991      | 12  |
| 8 *      | VOLUTE HSG GSKT      | 4156GA      | 20000      | 1   | 39 *       | IMP SHIM SET       | 2X          | 17090      | 1   |
| 9 *      | SEAL PLATE           | 38272-520   | 10010      | 1   | 40         | VOL HSG DRAIN PLUG | P04         | 15079      | 1   |
| 10       | BOTTLE OILER         | S1933       | ---        | 1   | 41         | IMP WASHER         | 6750A       | 17000      | 1   |
| 11       | PIPE COUPLING        | AE02        | 15079      | 1   | 42         | IMP CAPSCREW       | BT0804S     | 15991      | 1   |
| 12       | PIPE NIPPLE          | T0208       | 15079      | 1   | 43         | IMP LOCKWASHER     | J08         | 15991      | 1   |
| 13       | HEX HD CAPSCREW      | B0604       | 15991      | 4   | 44 *       | WEAR RING          | 4158A       | 10010      | 1   |
| 14       | LOCKWASHER           | J06         | 15991      | 4   | 45 *       | COVER PLATE GSKT   | 4635GA      | 20000      | 1   |
| 15       | DEFLECTOR            | 2352        | 19120      | 1   | 46         | COVER PLATE        | 4635        | 10010      | 1   |
| 16 *     | OIL SEAL             | S29         | ---        | 1   | 47         | STUD               | C0606       | 15991      | 4   |
| 17       | BALL BEARING         | S1088       | ---        | 1   | 48         | HEX NUT            | D06         | 15991      | 4   |
| 18       | LUBRICATION AIR VENT | S1703       | ---        | 1   | 49         | SUCTION FLANGE     | 1753A       | 10010      | 1   |
| 19       | PEDESTAL             | 7639C       | 10010      | 1   | 50         | STUD               | C1009       | 15991      | 4   |
| 20       | ROTATION DECAL       | 2613M       | ---        | 1   | 51         | HEX NUT            | D10         | 15991      | 4   |
| 21       | BALL BEARING         | S375        | ---        | 1   | 52         | IMPELLER KEY       | N0406       | 15990      | 1   |
| 22       | BEARING CAP          | 38324-407   | 10010      | 1   | 53 *       | SUC FLANGE GSKT    | 1674GB      | 20000      | 1   |
| 23       | SHAFT KEY            | N0610       | 15990      | 1   | 54         | NAME PLATE         | 38818-018   | 13990      | 1   |
| 24 *     | IMP SHAFT            | 38512-020   | ---        | 1   | 55         | FILL PLUG ASSY     | 48271-062   | ---        | 1   |
| 25 *     | OIL SEAL             | S1465       | ---        | 1   | NOT SHOWN: |                    |             |            |     |
| 26       | RETAINING RING       | S442        | ---        | 1   |            | DRIVE SCREW        | BM#04-03    | 17000      | 4   |
| 27       | HEX HD CAPSCREW      | B0605       | 15991      | 4   |            | STRAINER           | 26841-026   | ---        | 1   |
| 28       | LOCKWASHER           | J-06        | 15991      | 4   |            | LUBE DECAL         | 38816-079   | ---        | 1   |
| 29 *     | BRG CAP SHIM SET     | 48211-043   | ---        | 1   |            | SUCTION STICKER    | 6588AG      | ---        | 1   |
| 30       | PEDESTAL DRAIN PLUG  | P06         | 15079      | 1   |            | FL TO PRM STK      | 6588AH      | ---        | 1   |
| 31       | OIL LVL SIGHT GAUGE  | 26714-011   | ---        | 1   |            | DISCHARGE STICKER  | 6588BJ      | ---        | 1   |

\* INDICATES PARTS RECOMMENDED FOR STOCK

## THE GORMAN-RUPP COMPANY • MANSFIELD, OHIO

Printed in U.S.A.