

---

**AUTOMATIC AIR GREASE GUN  
MODEL 1162**

**PISTOLET PNEUMATIQUE A GRAISSE  
MODELE 1162**

**AUTOMATISCHE DRUCKLUFTFETTPRESSE  
MODELL 1162**

**ENGRASADOR NEUMÁTICO AUTOMÁTICO  
MODELO 1162**

US Patent 6,012,377

This grease gun conforms to the European Directive for Product Safety.

Les Etats-Unis Font breveter 6,012,377

Ce pistolet à graisse est conforme aux directives européennes de sécurité

Vereinigte Staaten Patentieren 6,012,377

Diese Fettpresse entspricht der europäischen Vorschrift für Produktsicherheit

Estados Unidos Patentan 6,012,377

Este engrasador cumple con la directiva europea para la seguridad de productos.

**Table of Contents**

Safety.....2  
 Personal Safety.....2  
 Description.....2 & 3  
 Appropriate Use.....4  
 Specifications.....4  
 Work Area.....4  
 Inspection.....4  
 Operation.....4  
 Removing Empty Grease Cartridge.....4  
 Installation of Grease Cartridge.....4  
 To Convert Gun.....5  
 To Fill the Gun from Bulk Container.....5  
 To Fill the Gun with a Filler Pump.....5  
 To Expel Air Pockets.....5  
 Service Parts.....6 & 7  
 Troubleshooting.....8  
 French Version.....9 - 15  
 German Version.....16 - 22  
 Spanish Version.....23 - 29

**SAFETY**

Read and carefully observe these operating instructions before unpacking and operating the Air Grease Gun. The gun must be operated, maintained and repaired exclusively by a person familiar with the operation instructions. Operate the gun only after safety instructions and this operation manual are fully understood.

 **WARNING**

Extreme pressure may cause whip hose to burst. Use only LINCOLN APPROVED hoses and follow the hose instructions and warnings.

 **WARNING**

Grease gun can develop high pressure - up to 6,000 Psig (414 Bar). Use safety glasses and gloves for protection during operation. Keep hands clear of the exposed rubber portion of hose.

This grease gun generates high grease pressure. Extreme caution should be used when operating the gun as material leaks from loose and ruptured components can inject fluid through the skin and into the body causing serious bodily injury. Adequate protection is recommended to prevent splashing of material onto the skin or into the eyes.

 **WARNING**

If any fluid appears to penetrate the skin, get emergency medical immediately. Do not treat as a simple cut. Tell attending physician exactly what fluid was injected.

© Indicates change

**PERSONAL SAFETY**

1. Always wear eye protection. The Air Grease Gun can generate up to 6,000 Psig (414 Bar)
2. Use only Lincoln P/N 1218, 1224, 1230 or 1236 outlet whip hoses. Grease injection injuries are a very serious injury. Hold the hose only in the area of the spring guard.
3. Avoid accidental starting. Be sure trigger is not depressed when attaching inlet air hose.
4. Do not bend the hose in small radii.
5. Replace the hose at the first sign of wear, kink or damage to the outside jacket.

**QUICK START INSTRUCTIONS©**

1. Attach high pressure grease hose and coupler, (1) to outlet in the head (5). Copper gasket must be used to seal hose thread to head. Tighten securely.
2. Attach air coupler nipple (21) to port in bottom of handle (6) and tighten securely.
3. Fill grease container (See appropriate section of manual for various options).
4. Prime grease gun by operating slowly until grease flows from coupler (2). See Operation section for detailed priming procedure.
5. Adjust air pressure to grease gun as required, and gun is now ready for use.
6. Disconnect air supply to grease gun when not in use.

**DESCRIPTION**

Lincoln Air Operated Grease Gun is fully pneumatic operational and automatic unit. The gun was developed for manual lubrication of the grease points and has ability to stall in case of a blocked bearing, fitting or lubrication line. The gun is a positive displacement single action pump that delivers lubricant each time the plunger (13) moves forward.

©The gun features a throttling trigger valve. A slight pull of the trigger (8) will cause the gun to operate slowly. As more finger force is applied to the trigger, the speed of the gun will gradually increase until maximum speed is reached with the trigger fully pulled. The maximum speed of the gun is limited to reduce the problems associated with dispensing lubricant too quickly, such as damaging bearing seals or dust boots.

The gun operates when the trigger (8) is depressed. Air is admitted to Chamber A (see Fig 1.) and pushes the piston (7) with the plunger (13) to the left. Vent valve B is closed. The grease, under pressure from plunger (13), opens the check valve (3) and delivers one shot of the lubricant.

When the piston (7) reaches the bypass groove C (see Fig. 2) air is admitted into chamber D and opens the vent valve B. The air pressure from chamber A is vented through valve B and vent holes E to the chamber F which communicates with the atmosphere through the hole G. The air pressure is equalized on both sides of the piston (7) and the force of the spring (12) will return the piston to the initial position, recharging the gun (see Fig 1). Vent valve B will be closed and air from chamber D is vented through the bypass groove C to the atmosphere. The cycle repeats in the same manner while the trigger is depressed.

# AUTOMATIC AIR GREASE GUN MODEL 1162

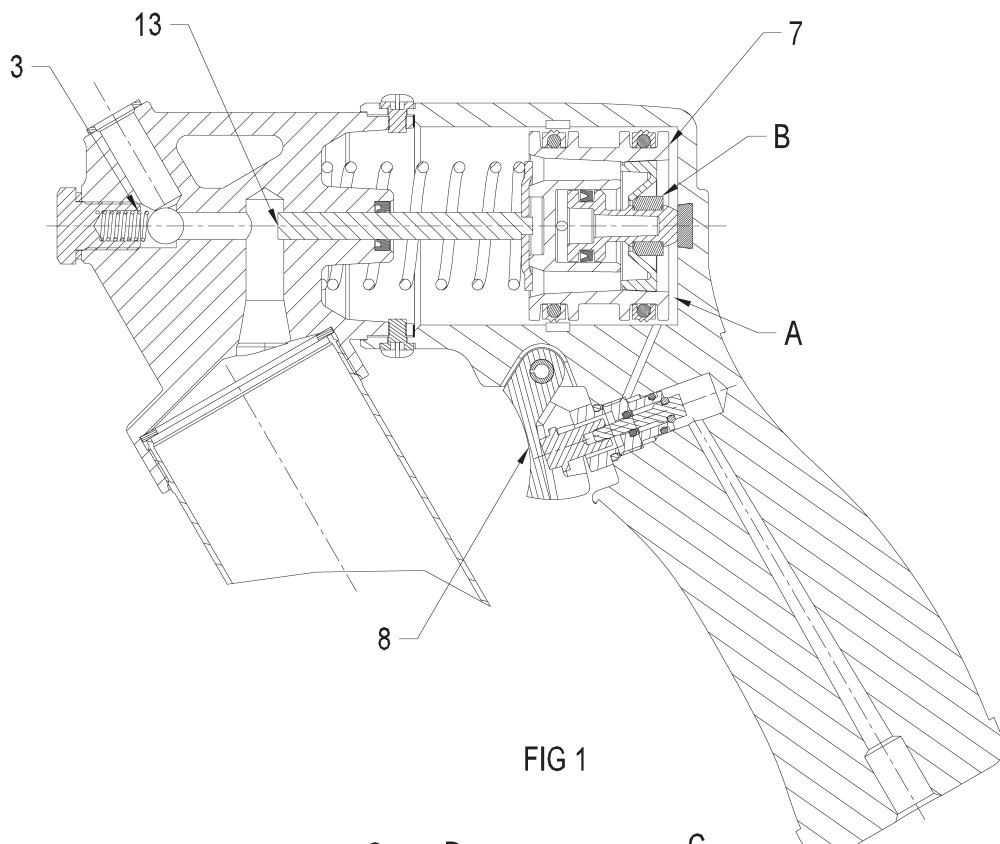

FIG 1

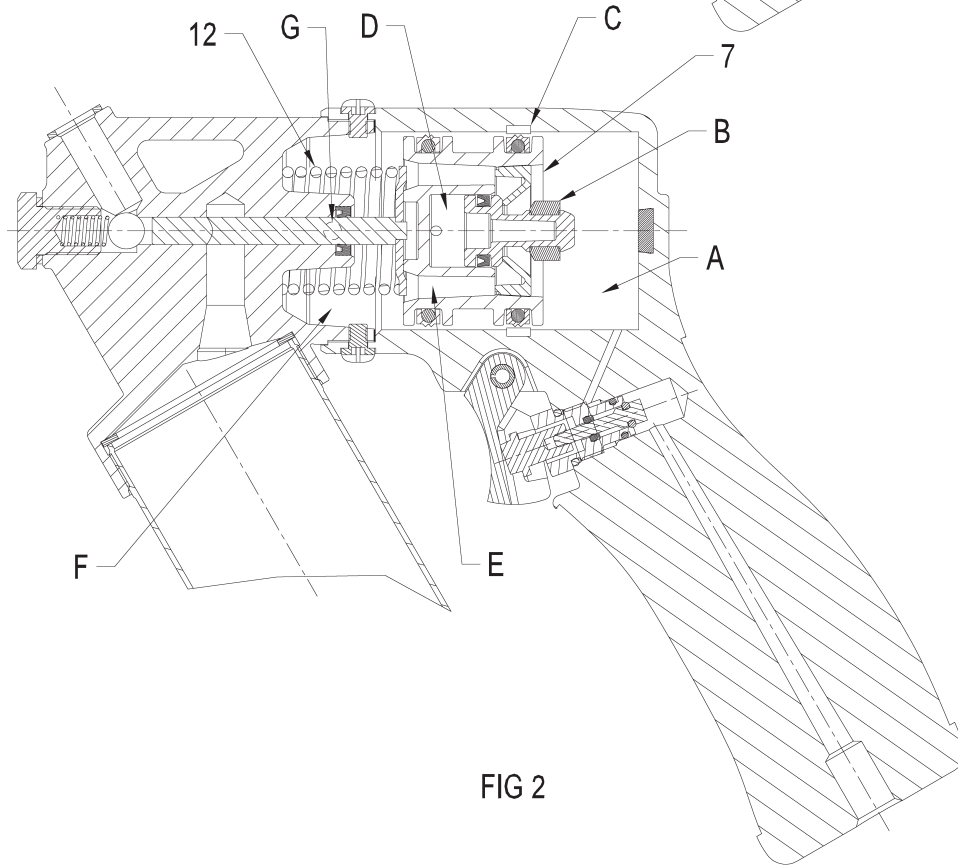

FIG 2

# AUTOMATIC AIR GREASE GUN MODEL 1162



## APPROPRIATE USE

- The Air Gun was exclusively designed to pump and dispense lubricant using pneumatic power.
- The maximum specification rating should not be exceeded.
- Any other use not in accordance with instruction will result in loss of claim for warranty or liability.

## SPECIFICATIONS

Pump ratio (max)	40:1
Output per stroke	.038 in <sup>3</sup> (0.62 cm <sup>3</sup> )
Pneumatic Inlet pressure (min)	40 Psig (2.7 Bar)
(max)	150 Psig (10.3Bar)
Grease output pressure (max)	6,000 Psig (414 Bar)
Grease reservoir capacity	14.5 oz (450 cm <sup>3</sup> )
Operating temperature range	0 to 120 °F (-18 to +50°C)
Weight (empty)	4.5 Lbs. (2.0 Kg)
Weight (full)	5.5 Lbs. (2.5 Kg)
Lubricant up to NLGI	#2 Grease
Pneumatic port inlet	1/4-18 NPSF
Grease Port Outlet	7/16-28 UNEF

## WORK AREA

Keep bystanders, children, and visitors away while operating. Distractions can cause you to make mistakes.

## INSPECTION

Visually inspect for damaged, loose or missing parts. If equipment is worn or damaged, remove from service. Contact an authorized service center for damage assessment or repair.

## OPERATION

Prime the Air Grease Gun after each refill or grease cartridge change. Prime the gun before using it to lubricate grease points.

For optimum performance and product life, add a few drops of lubricating oil (SAE 30 or greater) through the air fitting at the bottom of the handle if gun begins to cycle slowly or erratically.

© To prime, operate the gun slowly, by gently throttling the trigger (8), until grease flows from the open end of the hose. The vent/filler valve (18) should be used to expel air pockets. This is done by loosening the vent/filler valve a couple of turns, holding the gun with the discharge hose pointing up, and allowing the air to escape. Close the vent/filler valve after air is removed. If a prime can not be achieved after the gun has operated for 10-15 seconds, see the section "TO EXPEL AIR POCKETS".

© The gun will stall if a bearing or fitting is blocked, causing the grease pressure to rise to maximum. A blocked bearing or fitting should be corrected before continuing lubrication.

## CAUTION

Air pockets in the cartridge lubricant will cause the gun to lose prime.

## REMOVING EMPTY GREASE CARTRIDGE

- 1) Pull back on the follower handle until the follower rod is fully extended and latch the follower rod groove into the slot on the tube cap.
- 2) Unscrew the grease tube assembly from the gun.
- 3) Carefully release the follower handle to the eject the empty cartridge from container tube.

## INSTALLATION GREASE CARTRIDGE

- 1) Visually check the follower seal lip direction before loading a new cartridge. The follower seal lip must be directed toward handle or rear side for cartridge loading. To change the direction of the follower seal, unscrew tube cap from grease tube assembly and pull on the handle to remove follower seal from tube. Flip follower seal over and reassemble.
- 2) Pull back on the follower handle and latch the follower rod groove into the slot on the tube cap.
- 3) Remove the plastic cap from the grease cartridge and insert cartridge into container tube.
- 4) Remove the pull tab from the grease cartridge and screw grease tube assembly into pump assembly.
- 5) Release follower rod from slot. Purge air from pump. See air purging instruction.

# AUTOMATIC AIR GREASE GUN MODEL 1162



## TO CONVERT GUN TO ALLOW FILLING FROM BULK CONTAINER OR FILLER PUMP

- 1) Unscrew the container cap from the container tube. Pull on the follower handle to extract the follower and spring from the container tube.
- 2) Grasp follower between thumb and forefinger and flip the follower lip from the rear to the front side.

NOTE: The follower resembles a cup. When the gun is assembled for use with bulk lubricant, the cup opens toward the head assembly.

- 3) Reassemble follower into container tube and position with the follower handle so that the container cap can be tightened onto the container tube.

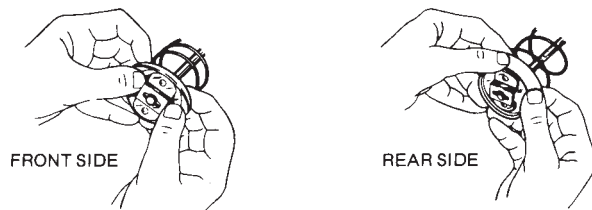

Fig. 3

## TO FILL THE GUN FROM BULK CONTAINER

- 1) Remove head and plunger assembly from container tube.
- 2) Pack lubricant into cavity of the head and plunger assembly.
- 3) Insert the open end of the container tube into lubricant. Slowly pull the follower handle back while pushing the container tube deeper into the lubricant to prevent air pockets from being pulled into the container tube.
- 4) When the follower rod is fully extended, pull it sideways to latch the rod groove into the keyhole slot in the container cap.
- 5) Loosely assemble the head and plunger assembly to the filled container tube. Release the follower rod from the follower by rotating the follower handle. Push the follower rod into the container. Slowly unscrew the container tube from the head and plunger assembly until lubricant oozes from the interface. Tighten container tube into the head and plunger assembly.

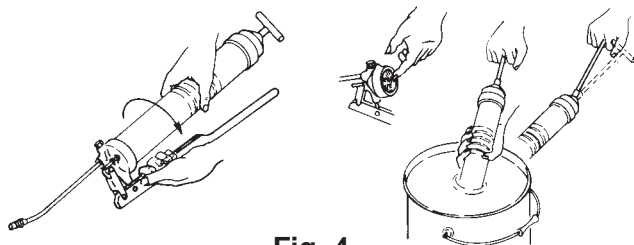

Fig. 4

## TO FILL THE GUN WITH A FILLER PUMP

Engage the follower rod with the follower by rotating the follower handle. Insert the gun filler nipple into the filler pump socket. Operate the filler pump to fill the container. When the follower rod groove is exposed, the container is filled (follower rod will be extended approximately 8 inches or 20 cm). Disengage the follower rod from the follower by rotating the follower handle. Push the follower rod into the container.

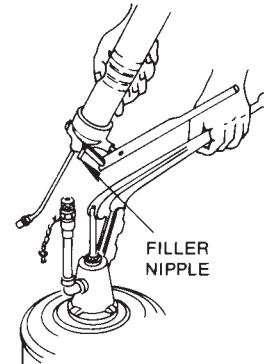

Fig. 5

## TO EXPEL AIR POCKETS

- 1) Withdraw the follower rod from the grease tube assembly cap and engage it with the follower by rotating the follower handle. Exert the force on the follower handle after opening the vent/filler fitting (18) (see Fig. 6).
- 2) Pull the trigger in short bursts to operate gun until trapped air is expelled. Disengage the follower rod from the follower by rotation the follower handle. Push the follower rod into the grease tube assembly.
- 3) If the step 2 fails, unscrew the grease tube assembly 1-1/2 turns from the pump assembly.
- 4) Exert force on the follower handle until lubricant oozes from the grease tube assembly and pump assembly interface.
- 5) Tighten grease tube assembly into the pump assembly. Disengage the follower rod from the follower by rotation the follower handle. Push the follower rod into the grease tube assembly.

**SERVICE PARTS**

NO.	PART NO.	DESCRIPTION	INCLUDE	QTY
1	1230	Hose 30"	Hose 30"	1
			Gasket	1
			Label warning	1
2	5852	Coupler hydraulic	Coupler,midget	1
3	274985	Kit Outlet Check	Spring Housing	1
			Ball	1
			Check Spring	1
			Gasket	1
4	272065	Grease tube	Container assy	1
			Label warning	1
5	274984	Head	Head machined	1
			Screw 10-32 x 1/4	4
			Packing(head-tube)	1
			Gasket (handle-head)	1
			Wiper rod	1
			Valve vent/loader	1
6	274983	Handle	Handle machined	1
			Screw 10-32 x 1/4	4
			Gasket (handle-head)	1
			Bumper	1
			Logo Left	1
			Logo Right	1
			Name plate	1
			Handle Grip	1
7	272068	Piston	Piston assy	1
			Screw 10-32 x 1/4	4
			Gasket (handle-head)	1
8	274982	Trigger	Trigger	1
			Roll pin	1
9	274981	Trigger valve	Trigger valve	1
			Roll pin	1
10	271880	Packing	Packing	1
11	272072	Follower	Follower assy	1
12	272073	Spring, piston	Return Spring	1
13	274980	Plunger	Plunger assy	1
14	272075	Crown seal	Crown seal	2
15	272076	Gasket	Gasket	1
16	272077	Wiper	Wiper rod	1
17	272078	Handle	Handle	1
18	286134	Vent/Bulk Valve Kit	Vent/Bulk Valve Kit	1
19	286092	Hose Clip	Hose Clip	1
20	286093	Coupler Cap	Coupler Cap	1
21	11659	Air Nipple	Air Nipple	1

# AUTOMATIC AIR GREASE GUN MODEL 1162

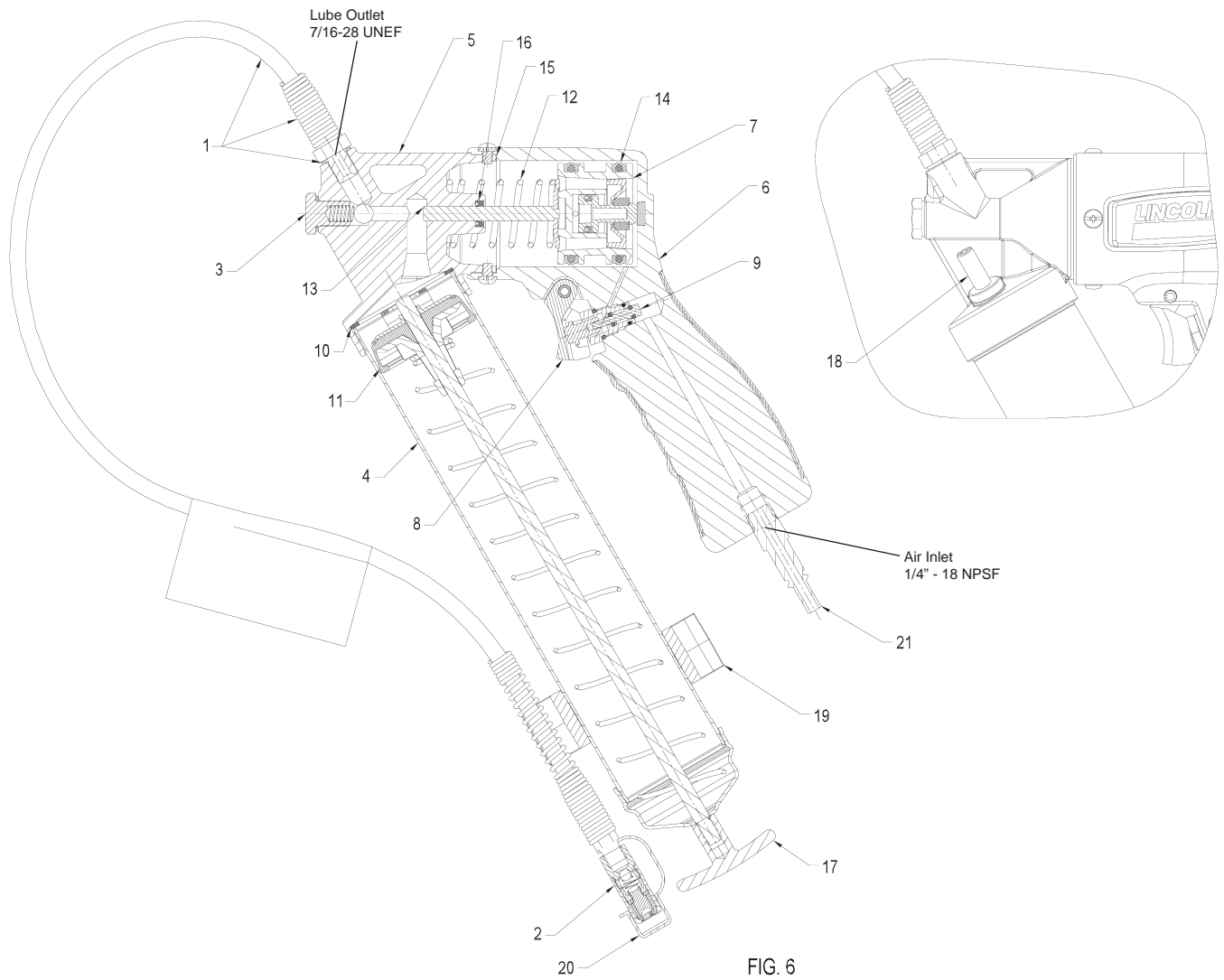

NOTE: Illustration shows follower seal lip positioned for cartridge use.

**TROUBLESHOOTING**

<b>Conditions</b>	<b>Possible cause</b>	<b>Corrective action</b>
The gun doesn't operate	No inlet air pressure.	Connect air supply.
	The piston (7) is stuck.	Dissassemble the gun, inspect for damage. Replace if necessary.
	Air pressure is too low.	Check air pressure supply. The pressure is to be higher 40 psi.
	Broken return spring (12).	Replace if necessary.
The gun doesn't operate automatically.	Air pressure is too low.	Check air pressure supply. The pressure is to be higher 40 psi.
	The piston (7) is stuck.	Disconnect air supply hose and hold on until the spring is retracted the piston back and cycle the gun. If the gun doesn't operate dissassemble the gun, inspect for damage. Replace the piston if necessary.
The gun cycles but doesn't pump grease.	Loss of prime.	Repeat priming operation.
	The container is out of grease.	Check that container has grease.
	Prime is not achieved after 10-15 seconds of operation.	Disconnect the extension hose or rigid extension and cycle the gun until grease flows from the outlet.
The gun continues to lose prime.	Air may be trapped in several locations in container after bulk filling.	Empty container, refill and repeat priming.
	The follower lips (11) are positioned wrong	Refer the paragraph on the container tube.
	The ball check valve (3) is not functioning.	Disassemble check valve, remove ball, clean and inspect ball seat area.
If the gun still doesn't operate.		Contact an authorized service center.